

# PARKMORE ROAD BUS PRIORITY SCHEME

## NEWSLETTER - ISSUE NO. 8

September 25, 2024

### WELCOME TO THE 8th ISSUE OF THE PARKMORE BUS PRIORITY SCHEME NEWSLETTER

Construction of the Parkmore Bus Priority scheme has been ongoing since February 19<sup>th</sup> with works substantially complete along Parkmore Road from the Monivea Junction to the Galway Racecourse Road Entrance. The following gives an outline of works planned for the next 4 weeks:

#### Phase 3 Works:

From Wednesday October 2<sup>nd</sup>, Phase 3 works on the East Footpath will be largely complete with works commencing on the western footpath.

#### Phase 3 Western Footpath works:

- Works will focus on the western footpath (Phase 3, Stage 2) shown in the adjacent image and will initially entail drainage, ducting and kerbing works.
- Temporary traffic management measures, including off-peak lane closures and temporary pedestrian and cycleway diversions, will be in place around the works areas as is necessary.
- From Wednesday October 2<sup>nd</sup>, pedestrians will be diverted along the Parkmore Road eastern footpath opposite Galway Technology Park with access to the Technology Park via the Pedestrian Crossing immediately north of the Technology Park entrance
- Initial Phase 3 Stage 2 works will focus on the western footpath between the north and south entrances to the Galway Technology Park with the works areas moving north and south as works progress. The initial works area is shown in yellow in the below diagram.

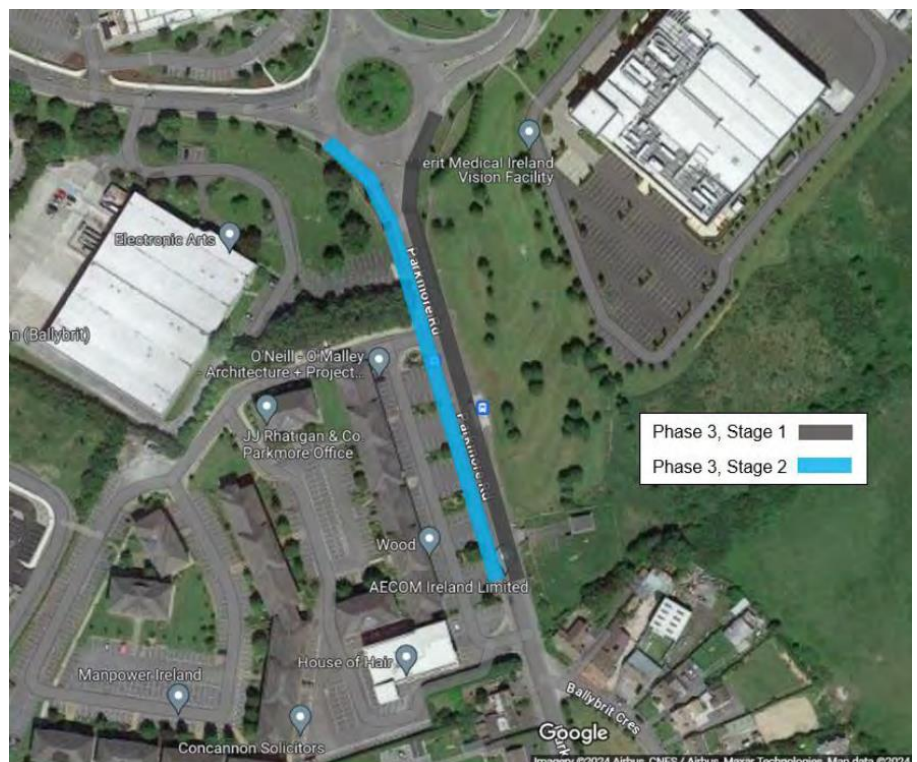
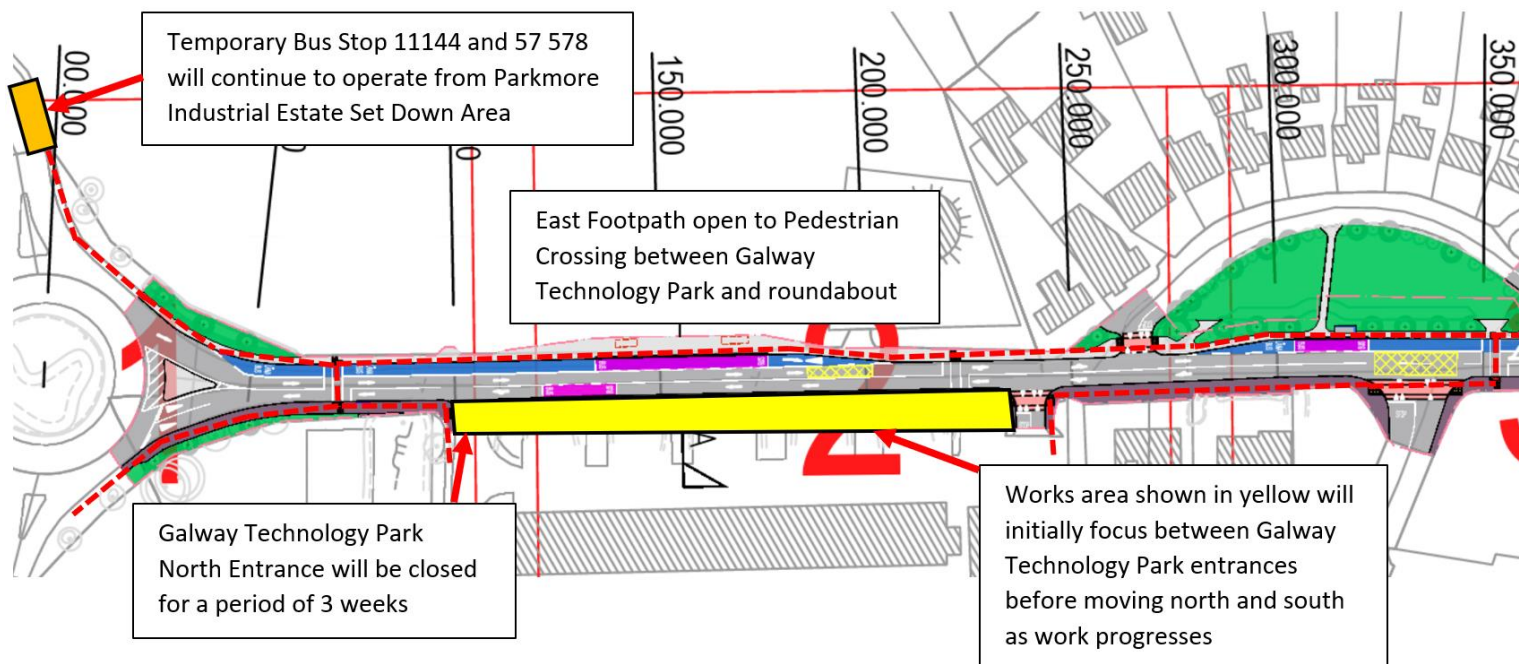

Figure 11 - Phase 3 – Stages 1 and 2



### Galway Tecnology Park Entrances and Relocated Bus Stops:

- Please note that the Galway Technology Park north entrance will be closed for around three weeks from Wednesday September 25<sup>th</sup>.
- Please also note that Bus Stops 11144 and 57 578 will continue to operate from the set down area within Parkmore East Business (adjacent to Merit Medical) as shown in the above image, and as per current temporary conditions.
- Temporary Pedestrian Diversion routes will be in place to facilitate access to the relocated bus stops shown by the dashed red line in the image above. Temporary pedestrian management signage will be in place advising of the new pedestrian routes and relocated bus stop locations.

**For further information:** Contact us at Jons Civil Engineering 0860835461 or [donalkelly@jonscivil.ie](mailto:donalkelly@jonscivil.ie)